

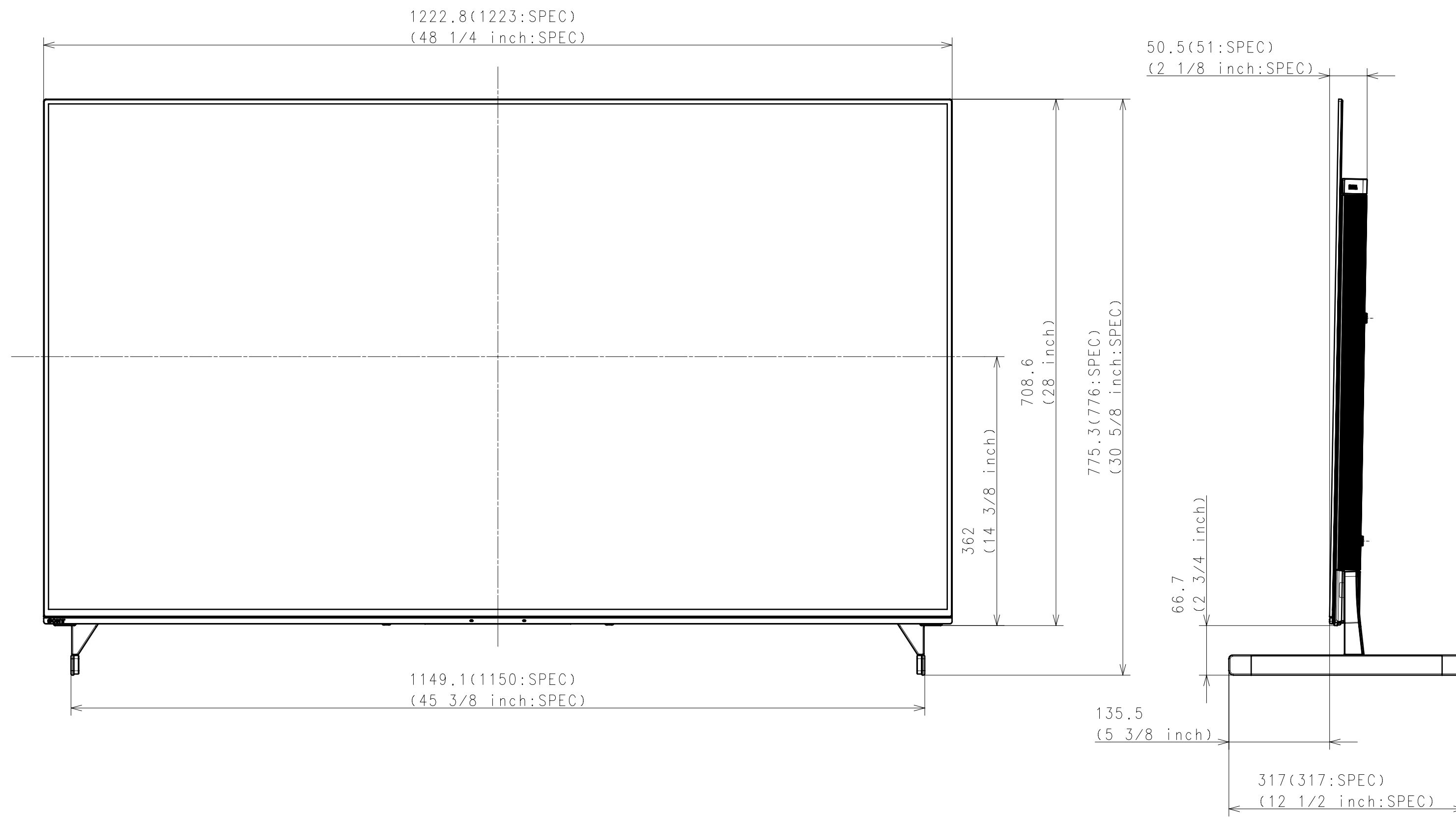

WITH STAND  
SOUND BAR POSITION

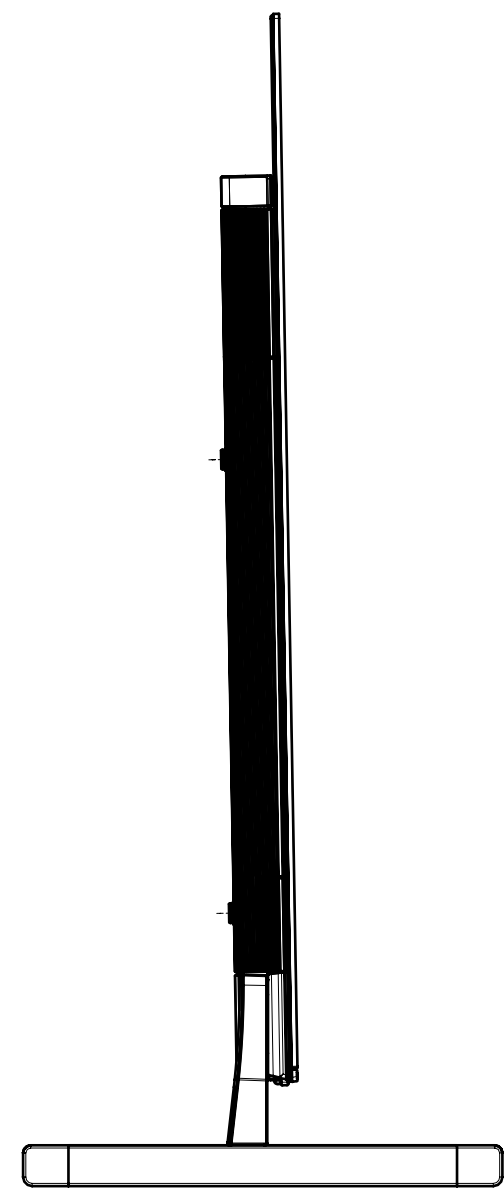

WITHOUT COVER

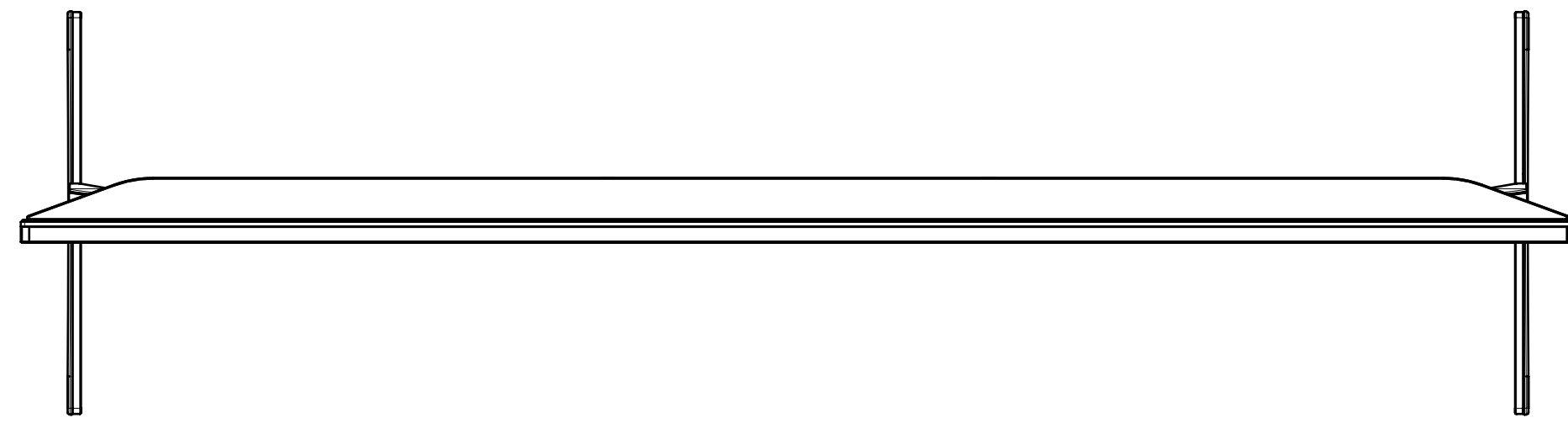
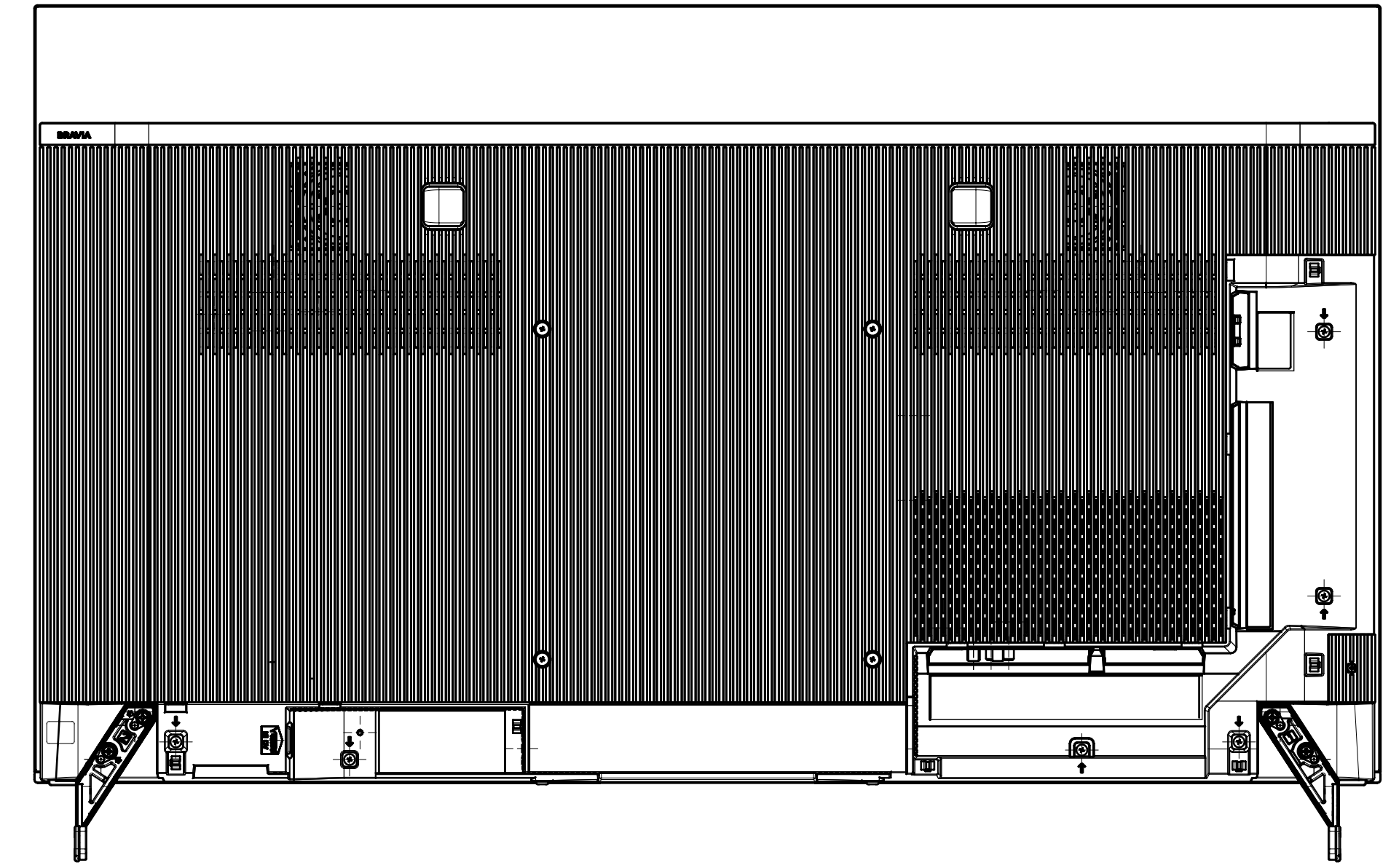

WITH COVER

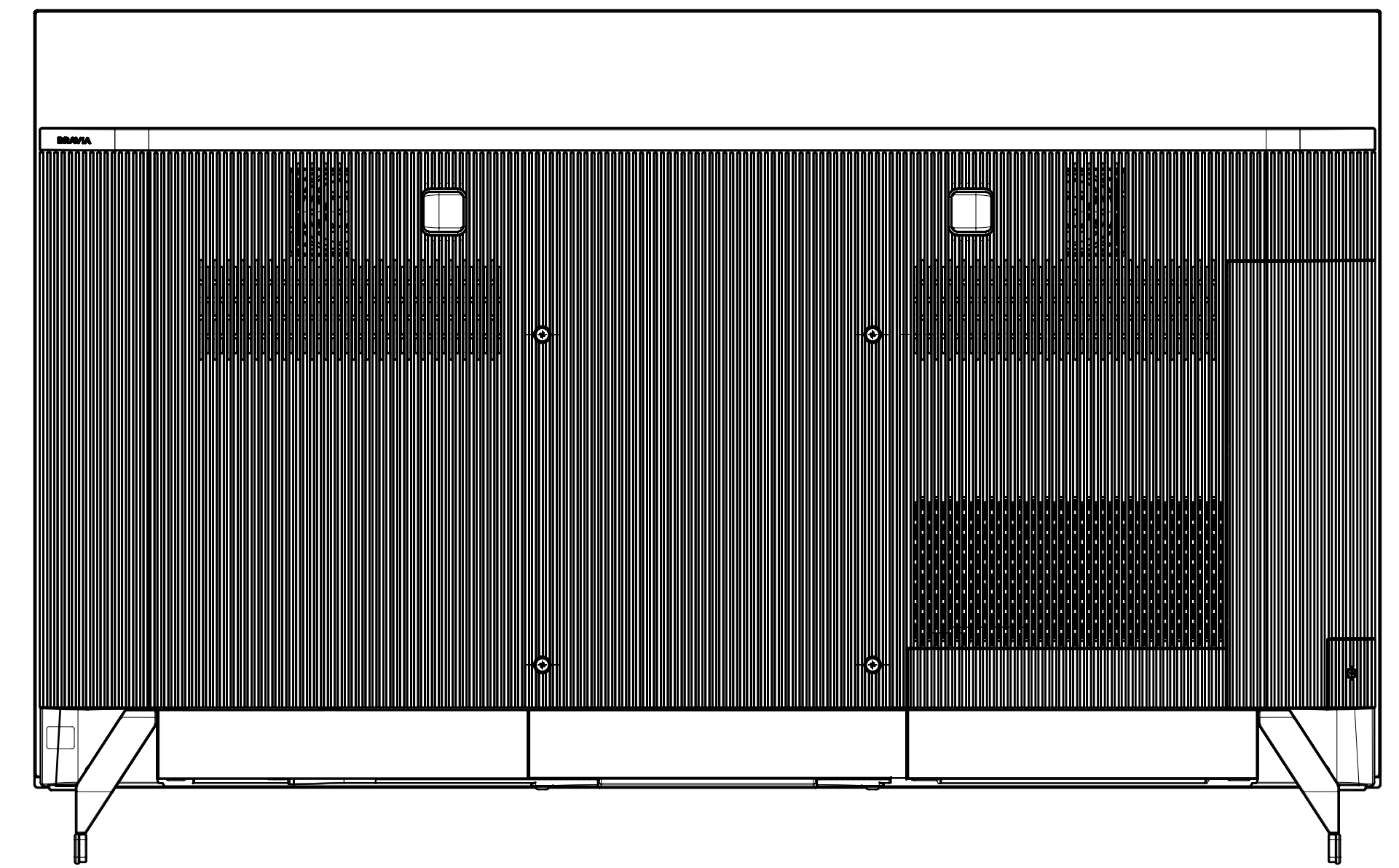

|                         |                  |             |
|-------------------------|------------------|-------------|
| DESCRIPTION             | LEGAL OWNER      | SCALE       |
| 55 (A90J) EXTERIOR VIEW | Sony Corporation | 1:5         |
| DESCRIPTION             | PART NO.         | SHEET/PAGES |
| 55 (A90J) EXTERIOR VIEW |                  | 2 / 4       |

WITHOUT STAND

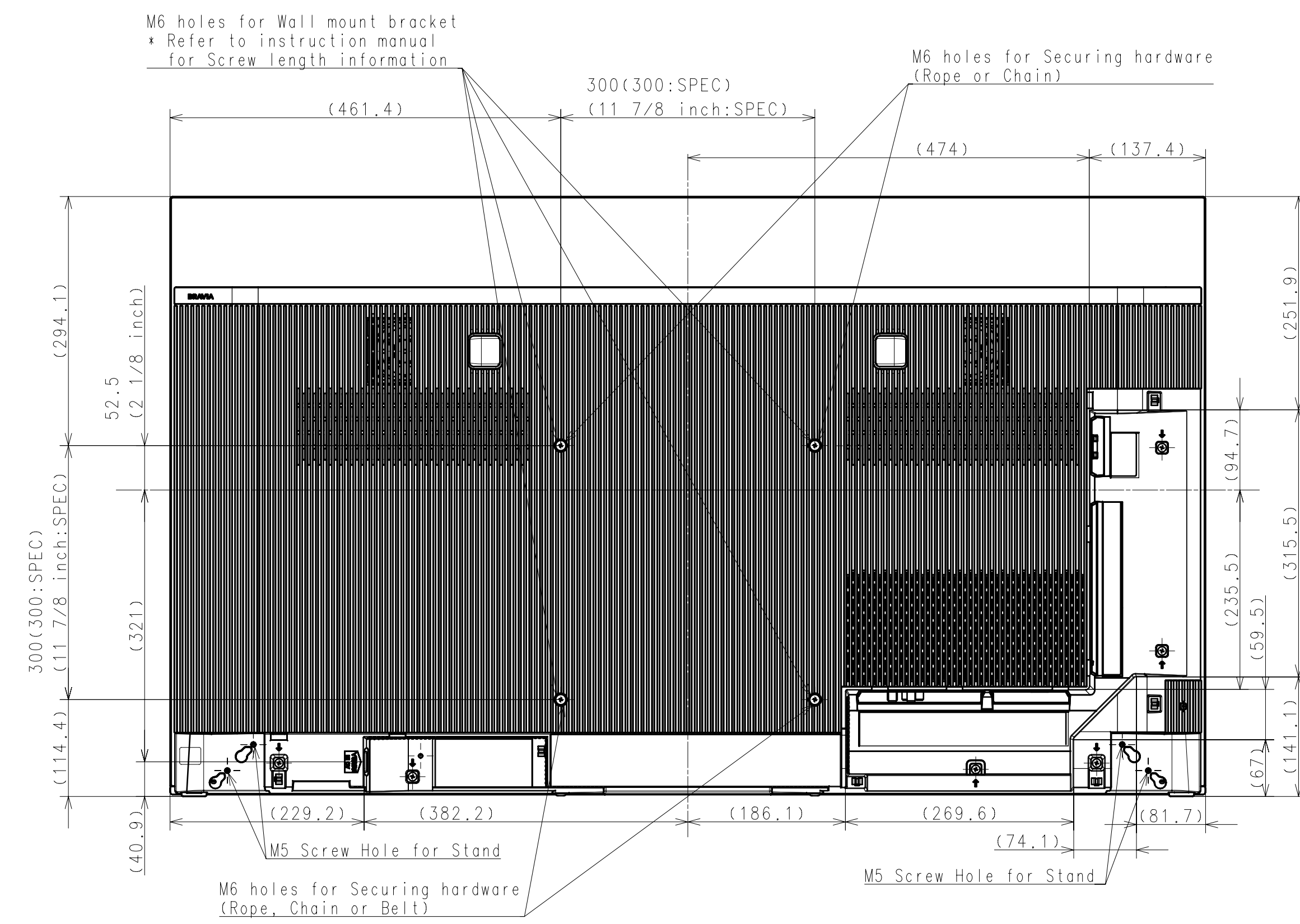
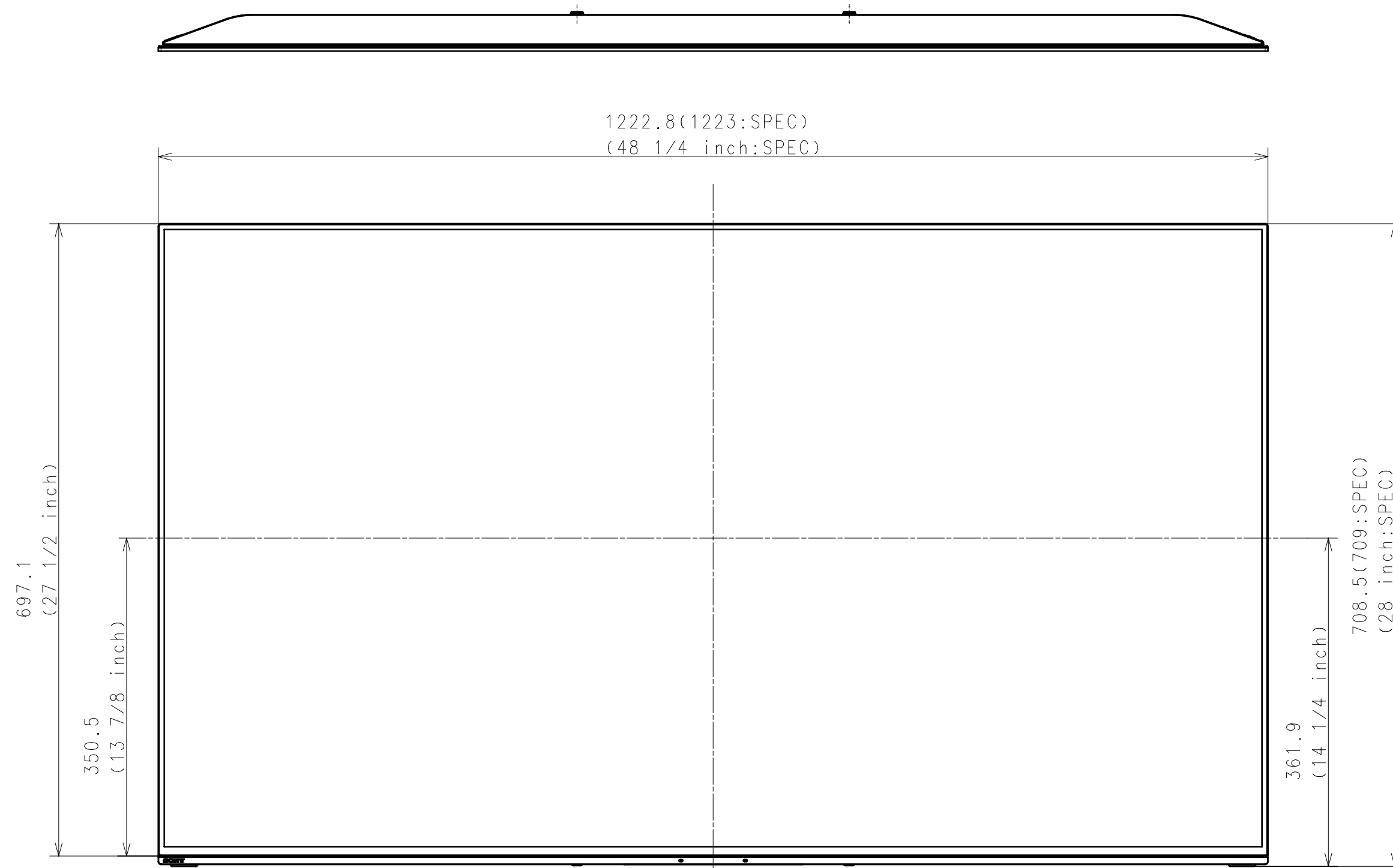

SU-WL450 SLIM

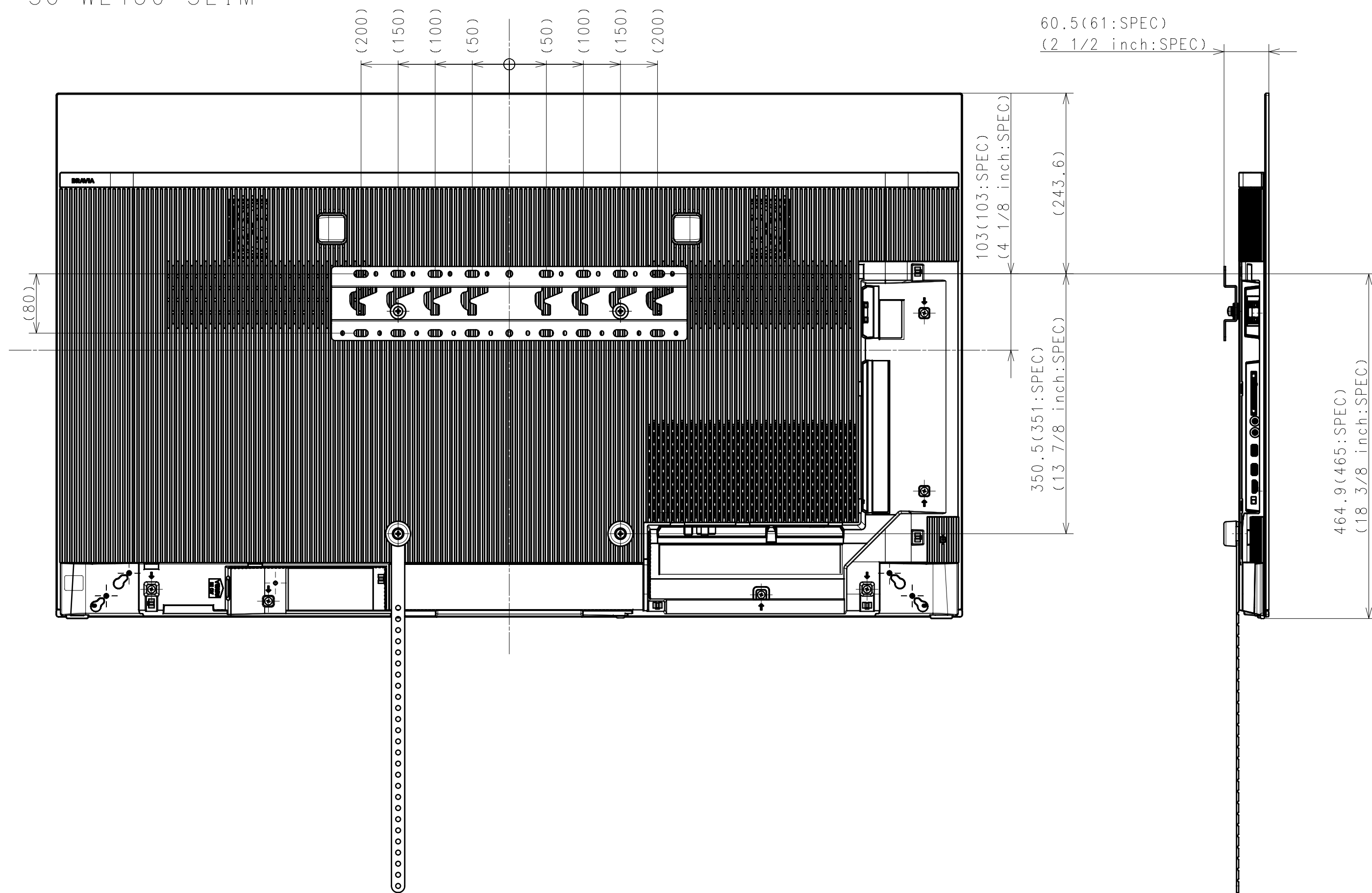

SU-WL450 STANDARD

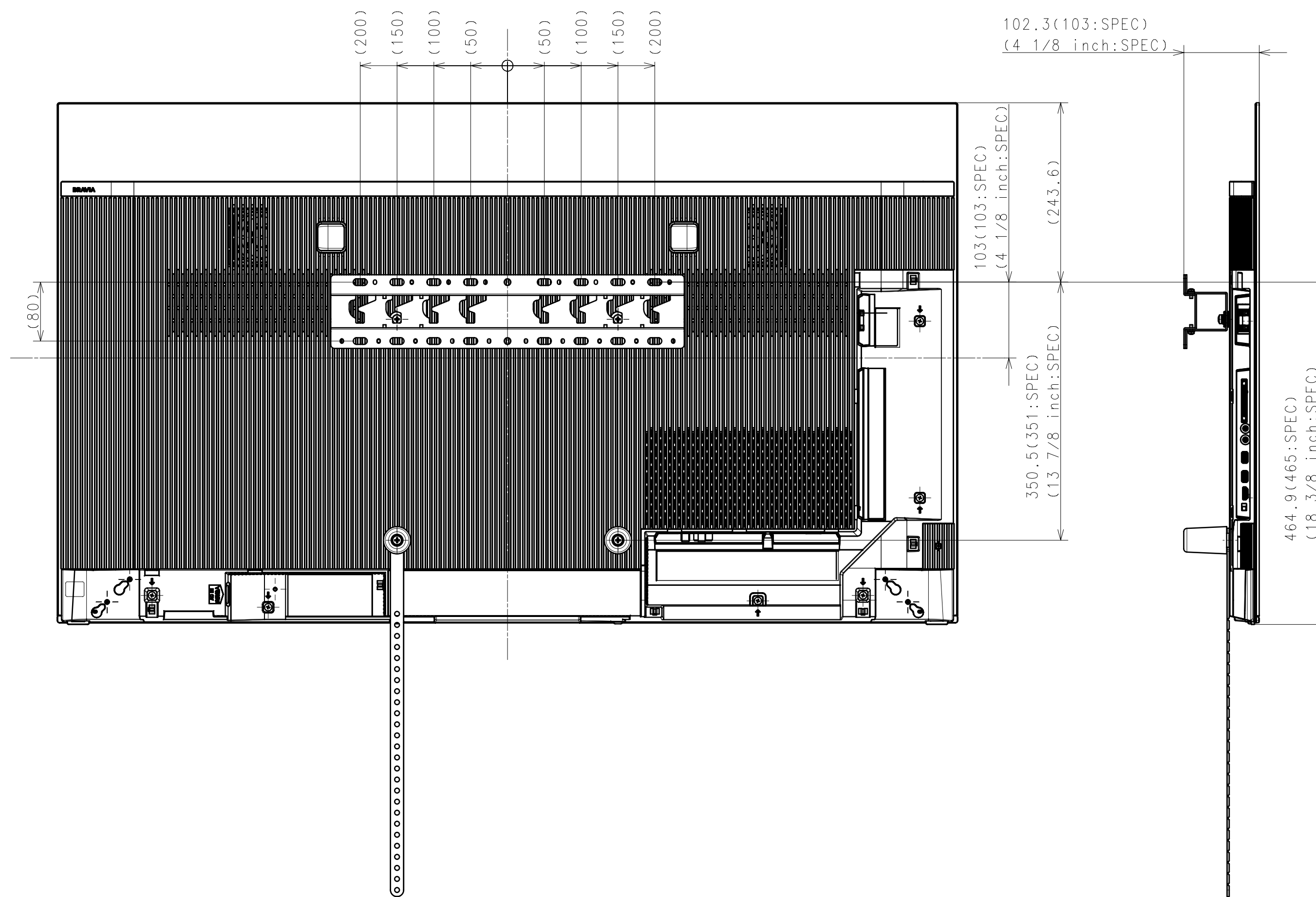

|                         |                  |             |
|-------------------------|------------------|-------------|
| DESCRIPTION 1           | LEGAL OWNER      | SCALE       |
| 55 (A90J) EXTERIOR VIEW | Sony Corporation | 1:5         |
| DESCRIPTION 2           | PART NO.         | SHEET/PAGES |
| 55 (A90J) EXTERIOR VIEW |                  | 3 / 4       |

SU-WL850

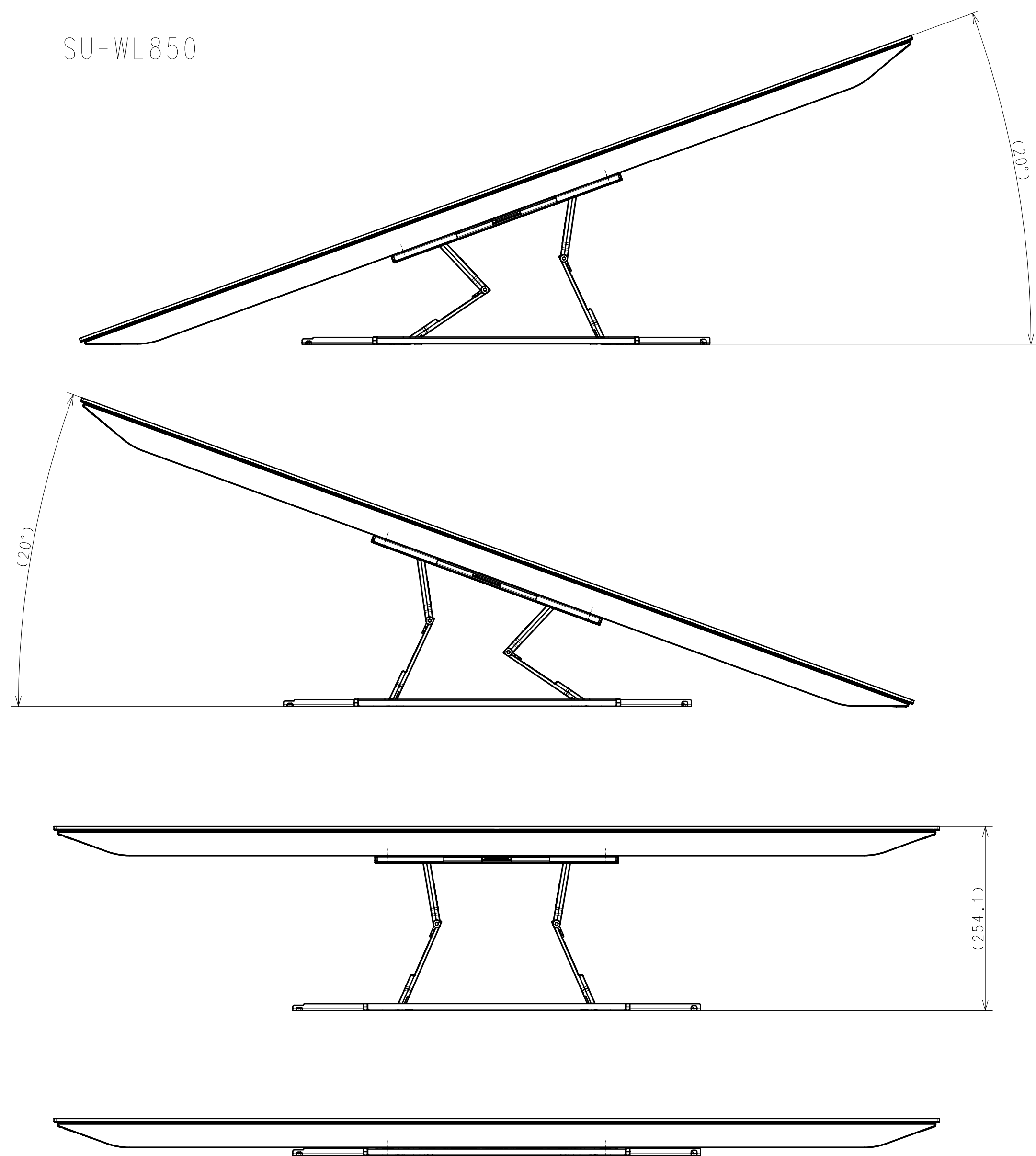

SU-WL855 with LATERAL SHAFT BRACKET

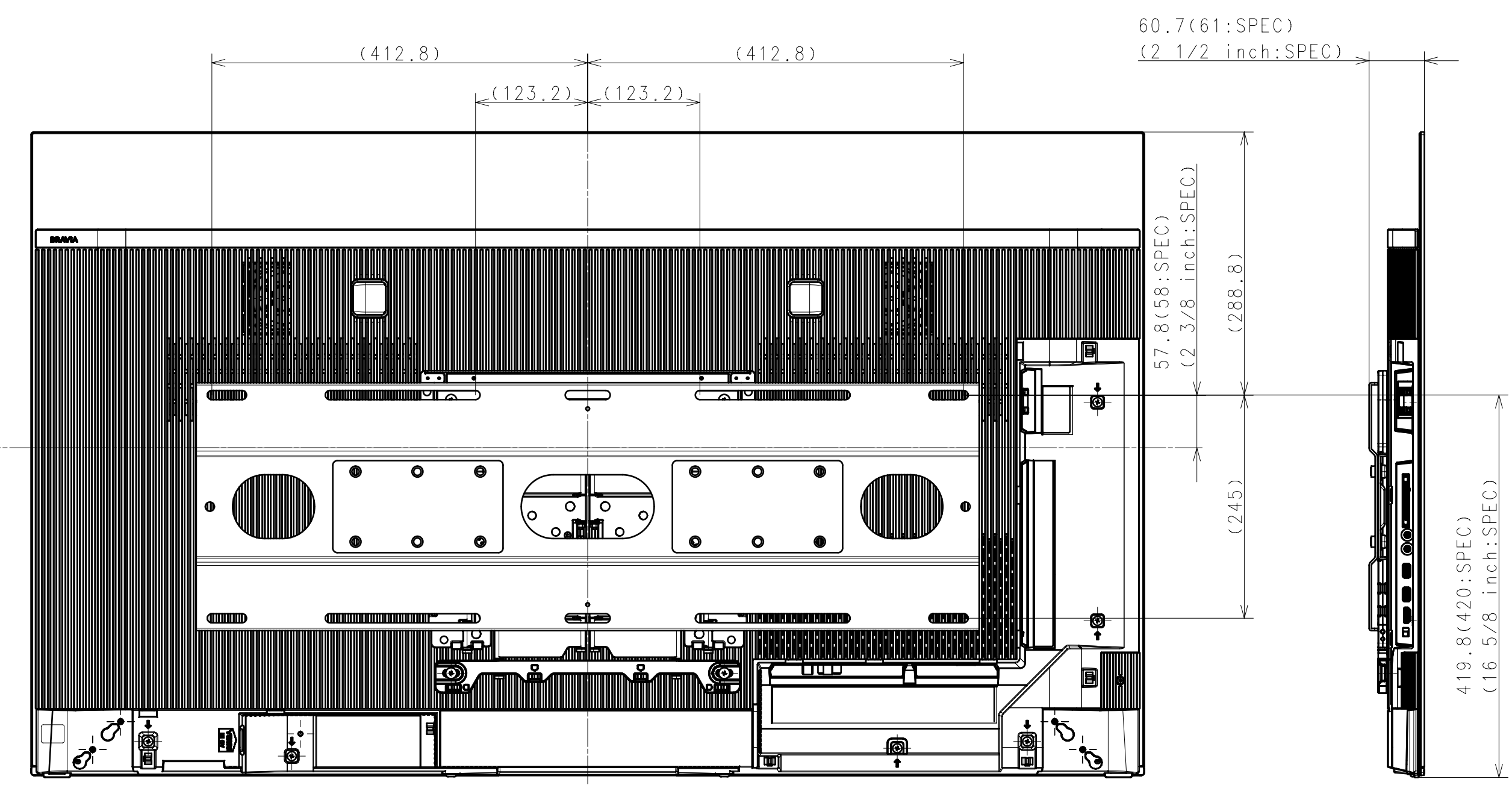
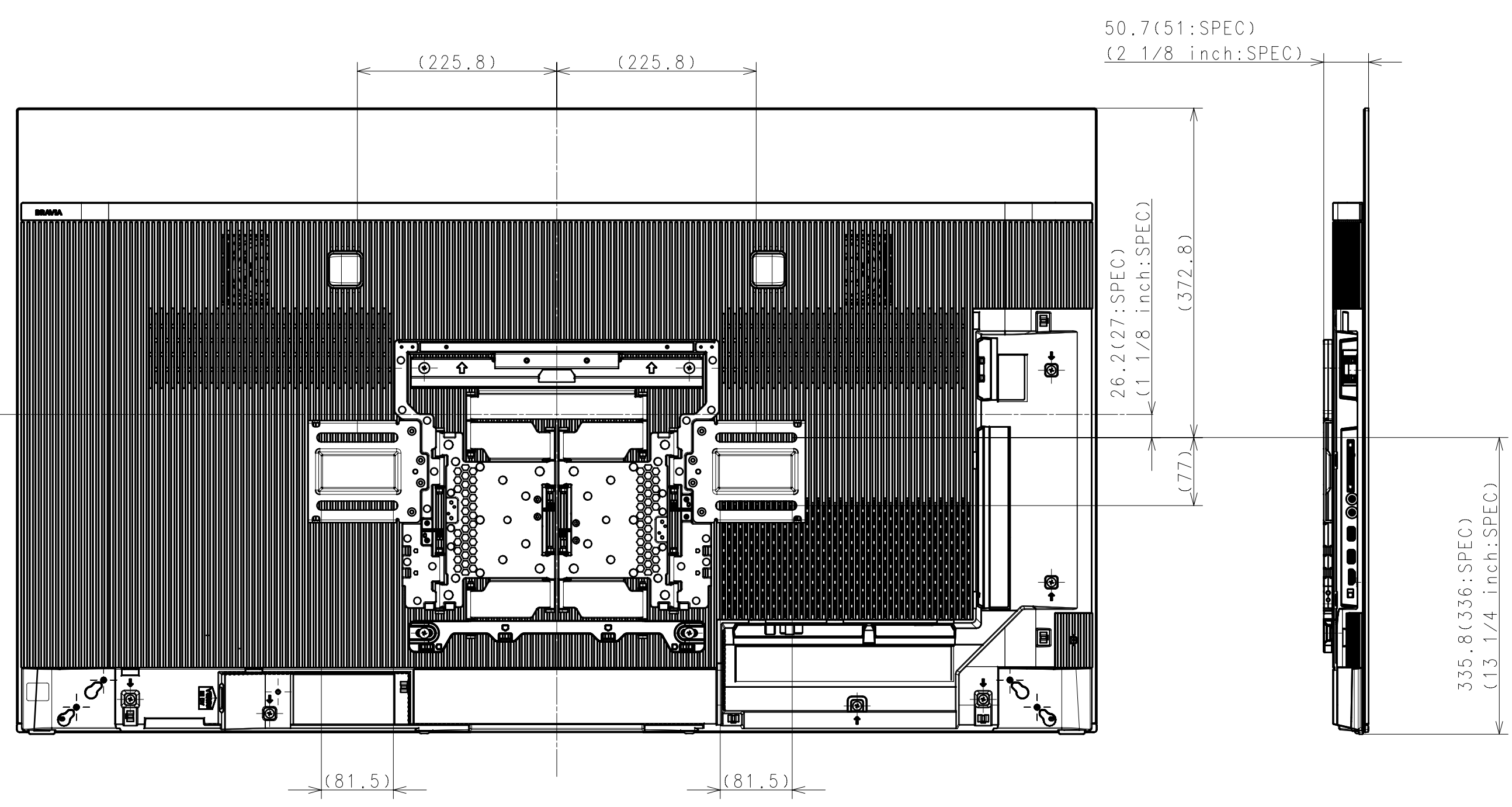
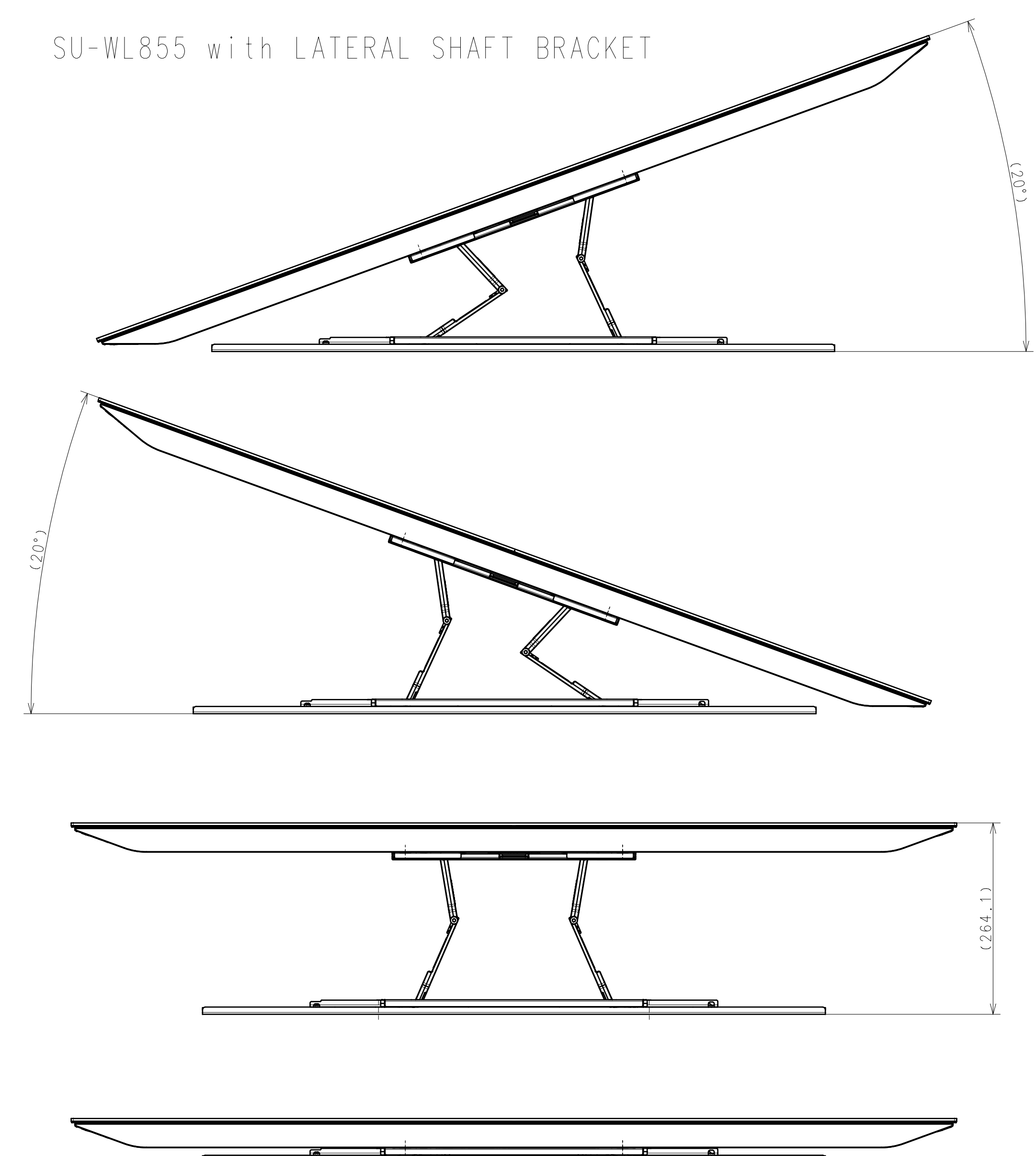

|               |                         |             |                  |             |       |
|---------------|-------------------------|-------------|------------------|-------------|-------|
| DESCRIPTION 1 | 55 (A90J) EXTERIOR VIEW | LEGAL OWNER | Sony Corporation | SCALE       | 1:5   |
| DESCRIPTION 2 | 55 (A90J) EXTERIOR VIEW | PART NO.    |                  | SHEET/PAGES | 4 / 4 |