

Area		NORTH AMERICA	LATIN AMERICA	GENERAL AREA
Model Name		KD-75X77L	KD-75X77L	KD-75X77L
SV No.		SV-41370	SV-41392	SV-41431
DIMENSION	TV only (W x H x D)	1686 x 969 x 72 mm / 66 1/2 x 38 1/4 x 2 7/8 inch	1686 x 969 x 72 mm	Approx. 1686 x 969 x 72 mm
	TV only with camera (W x H x D)	-	-	-
	TV with Stand (Standard position) (W x H x D)	1686 x 1045 x 415 mm / 66 1/2 x 41 1/4 x 16 3/8 inch	1686 x 1045 x 415 mm	Approx. 1686 x 1045 x 415 mm
	TV with Stand (Narrow position) (W x H x D)	-	-	-
	TV with Stand (Soundbar position) (W x H x D)	-	-	-
	TV with Stand (Front position style) (W x H x D)	-	-	-
	TV with Stand (Back position style) (W x H x D)	-	-	-
	TV with Floor Stand (W x H x D)	-	-	-
	Stand Width (Standard position)	1341 mm / 52 7/8 inch	1341 mm	Approx. 1341 mm
	Stand Width (Narrow position)	-	-	-
	Stand Width (Soundbar position)	-	-	-
	Stand Width (Front position style)	-	-	-
	Stand Width (Back position style)	-	-	-
Floor Stand Width	-	-	-	
VESA Hole Pitch	300 x 300 mm / 11 7/8 x 11 7/8 inch	300 x 300 mm	300 x 300 mm	
WEIGHT	TV Only	30.4 kg / 67 lb	30.4 kg	Approx. 30.4 kg
	TV with Stand (Standard position)	31.7 kg / 69.9 lb	31.7 kg	Approx. 31.7 kg
	TV with Stand (Narrow position)	-	-	-
	TV with Stand (Soundbar position)	-	-	-
	TV with Stand (Front/Back position style)	-	-	-
	TV with Floor Stand	-	-	-
	Floor Stand weight (Supply)	-	-	-
Remarks	W-M't Br. Weight (Supply)	-	-	-

WITH STAND

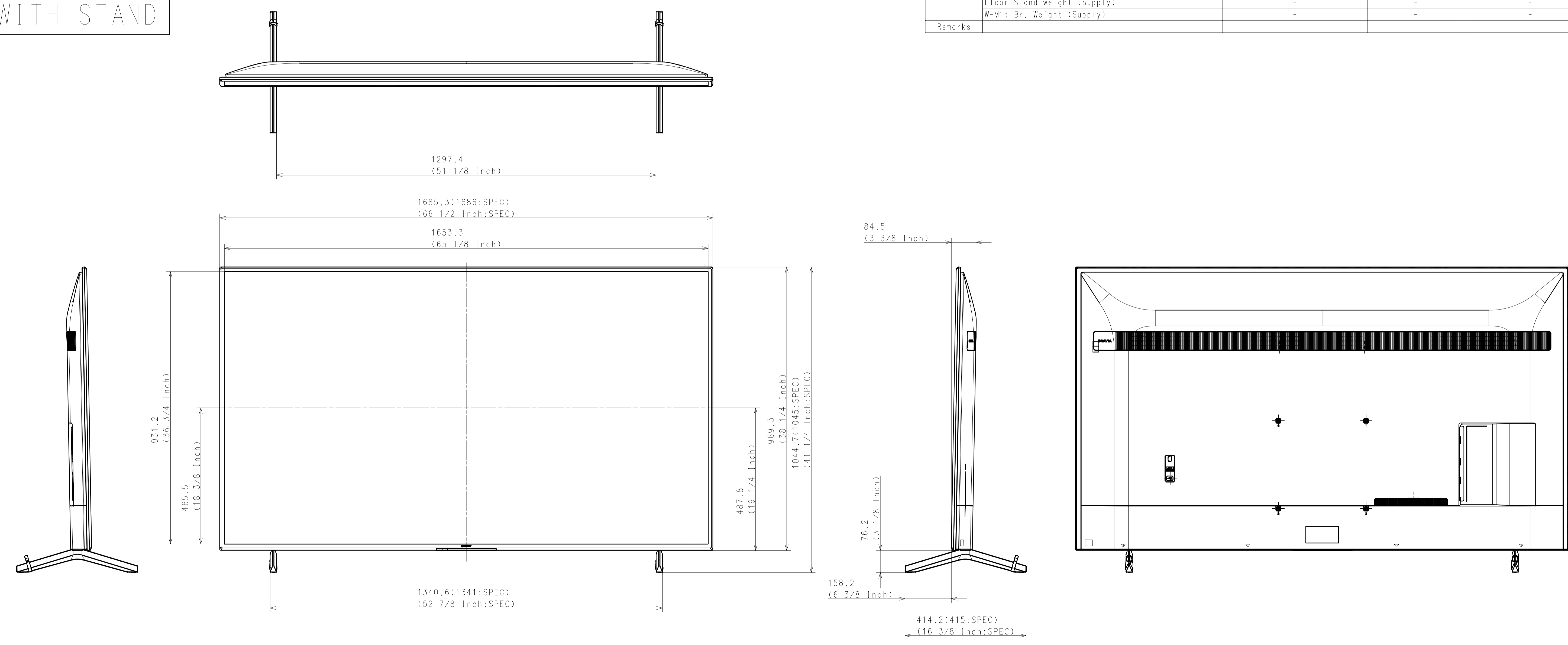

Purchase recycled resins and wire rods only from the business partners that Sony approves as Green Partners.
再生樹脂・銅線はグリーンパートナー認定品を使用してください。

△A										GENERAL TOLERANCE	DATE OF ISSUE 2022.12.20
△B											DOCUMENT TYPE ASSEMBLY
△C											TOLERANCING DRAWING (JIS & ISO/IEC 8015)
HISTORY X COUNT	SUFFIX REV. NO.	RELEASE NO. DATE	REVISION	SIGN.	MATERIAL COLOR	FINISH COLOR					
LEGAL OWNER Sony Corporation											
RESPONSIBLE DEPARTMENT				ORIGINAL MODEL	DESCRIPTIONS 75(X77L) EXTERIOR VIEW						
PLANNED BY				CHECKED BY	APPROVED BY	SCALE 1:7	TENTATIVE MODEL	DESCRIPTIONS 75(X77L) EXTERIOR VIEW			
DRAWN BY				PREP. METHOD	SIZE A1	UNIT mm	PAGE NO.	SUFFIX	REV. NO.	SHEET/PAGES 1/4	

WITHOUT STAND

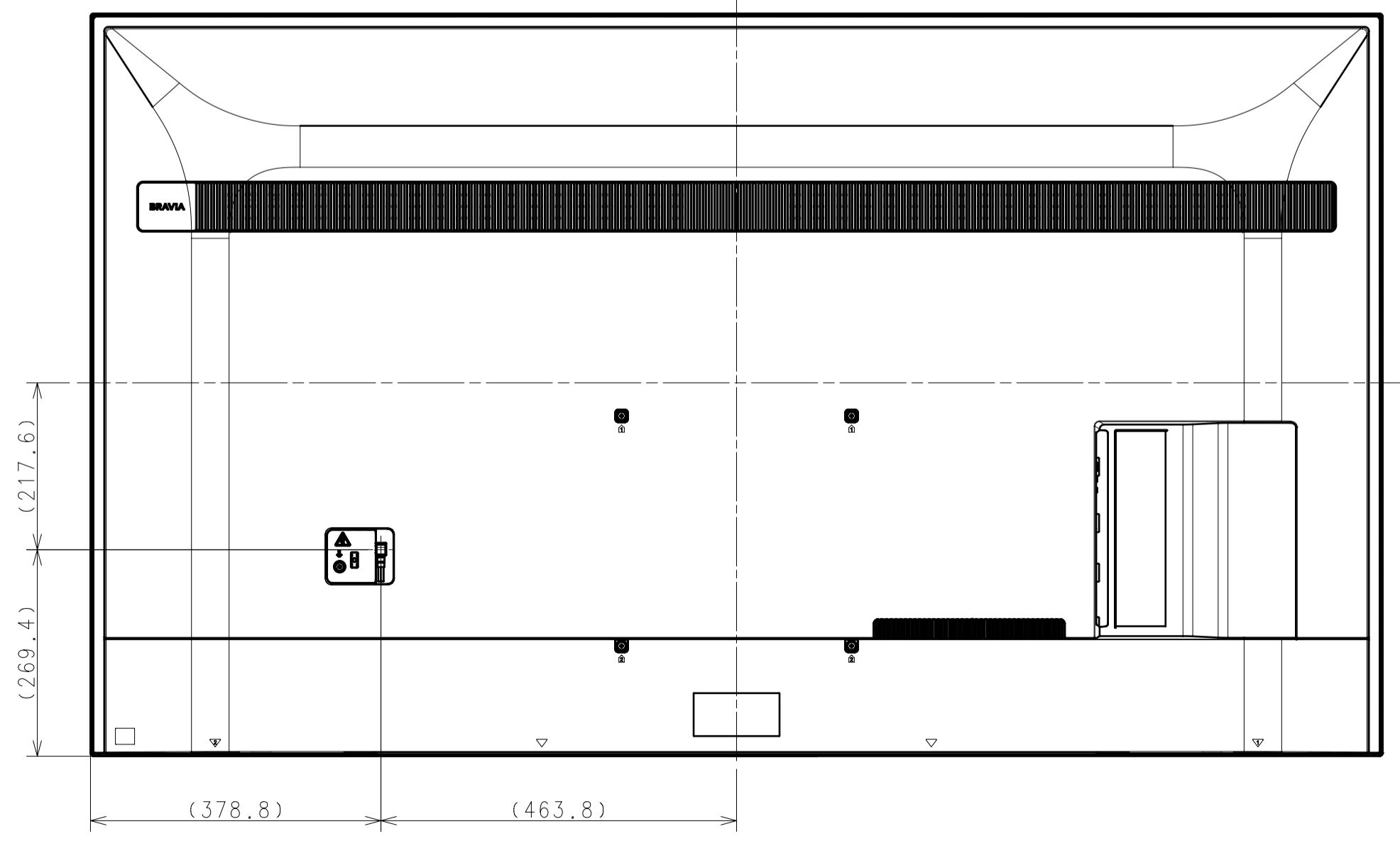
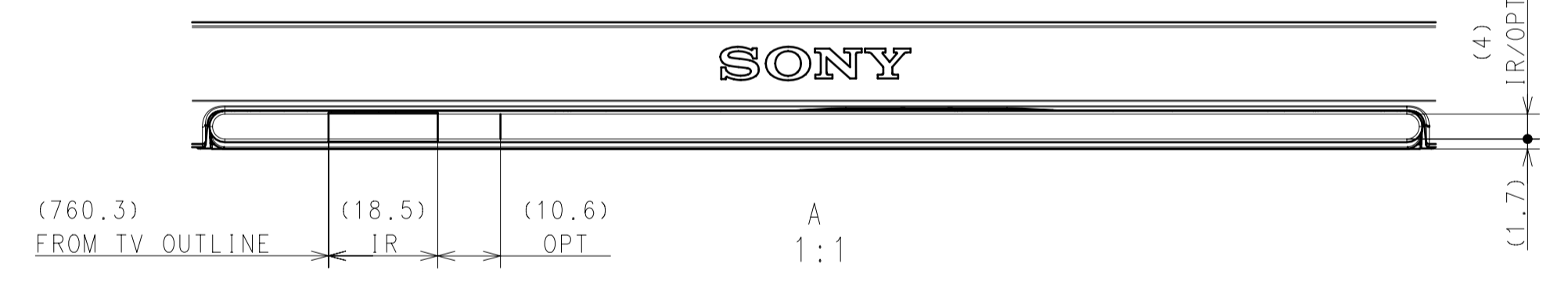
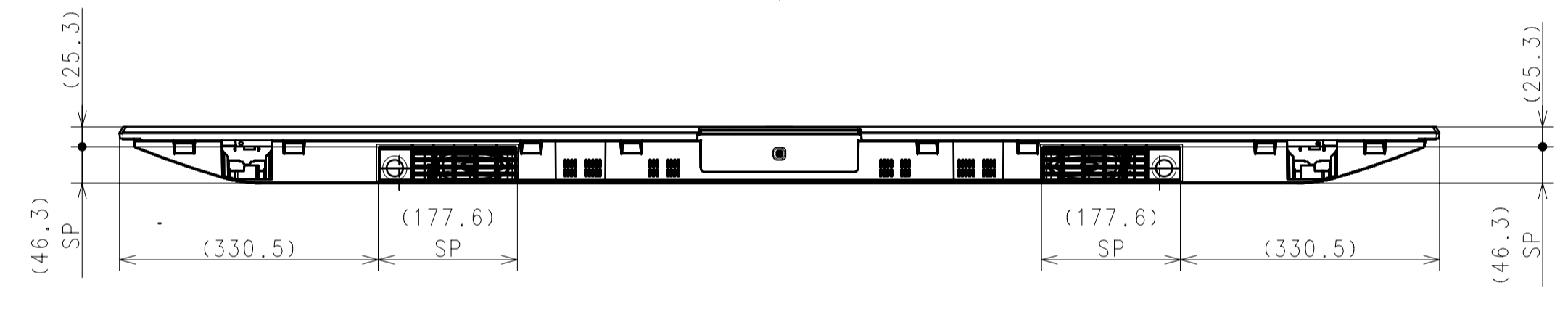
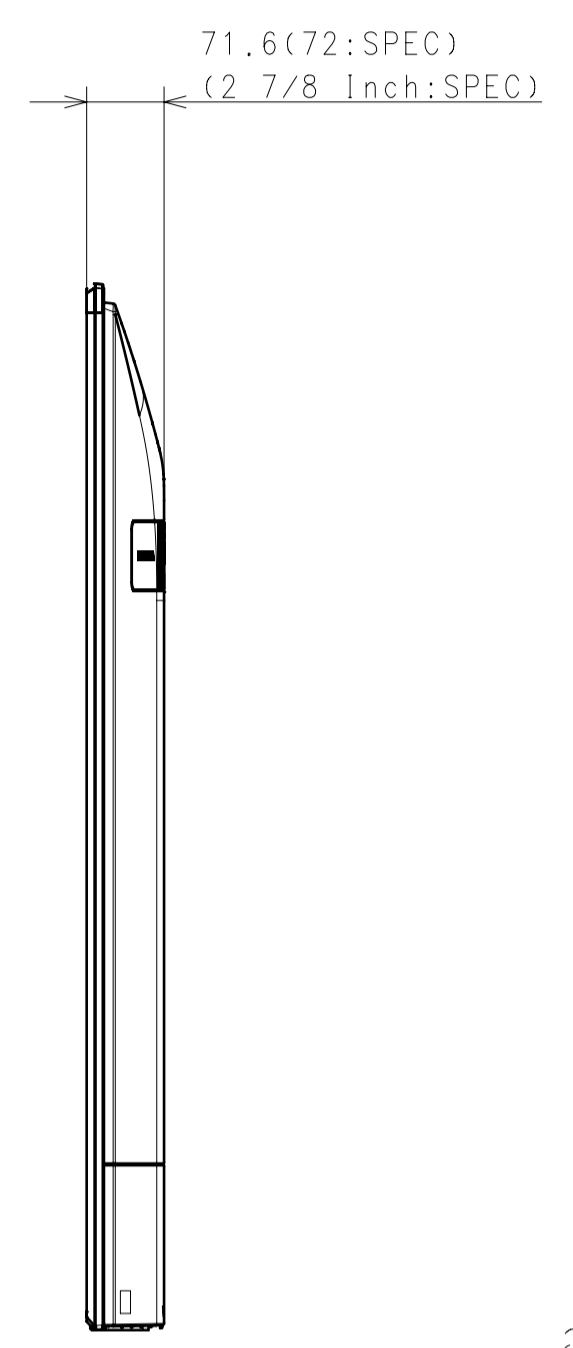
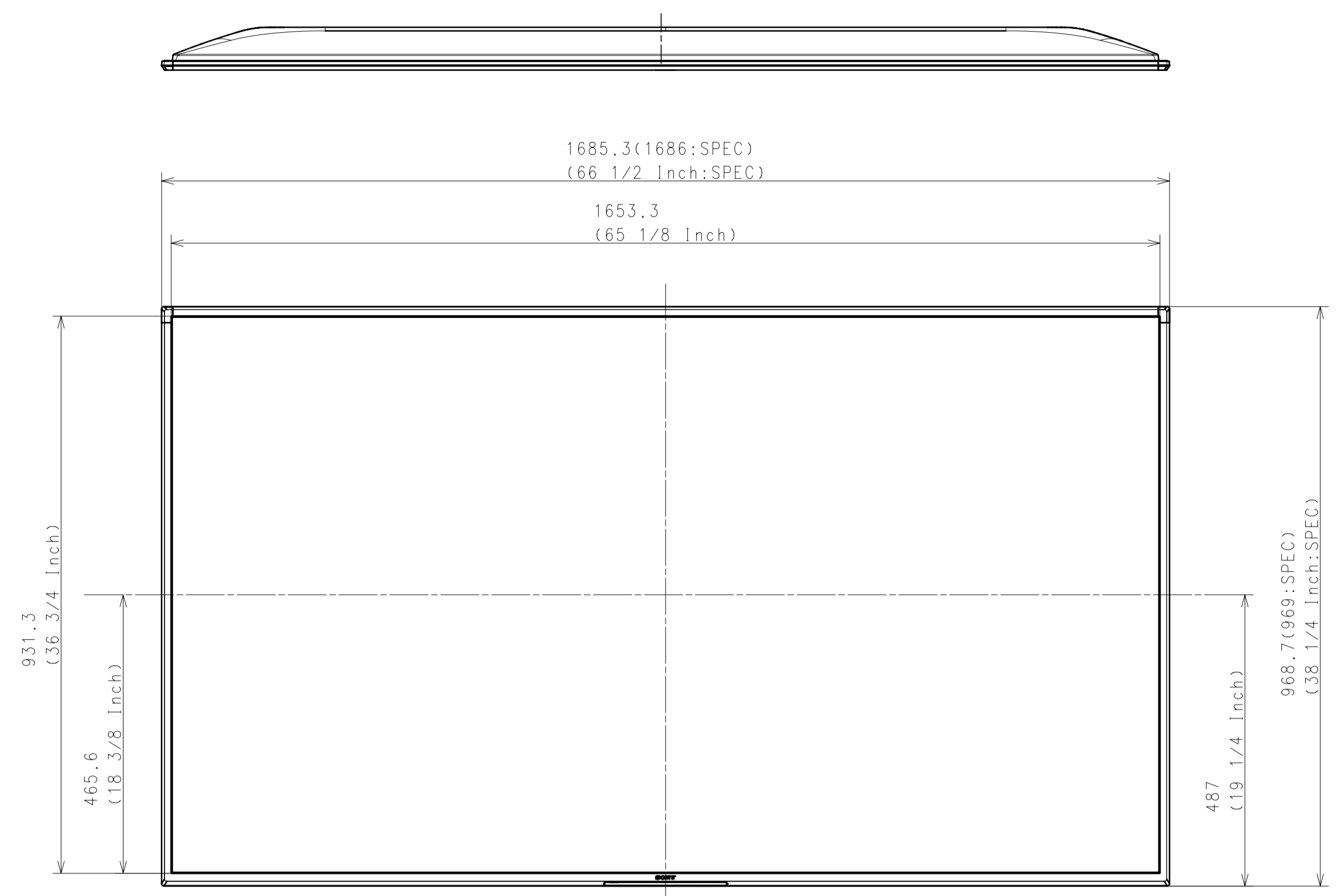

For LATIN AMERICA

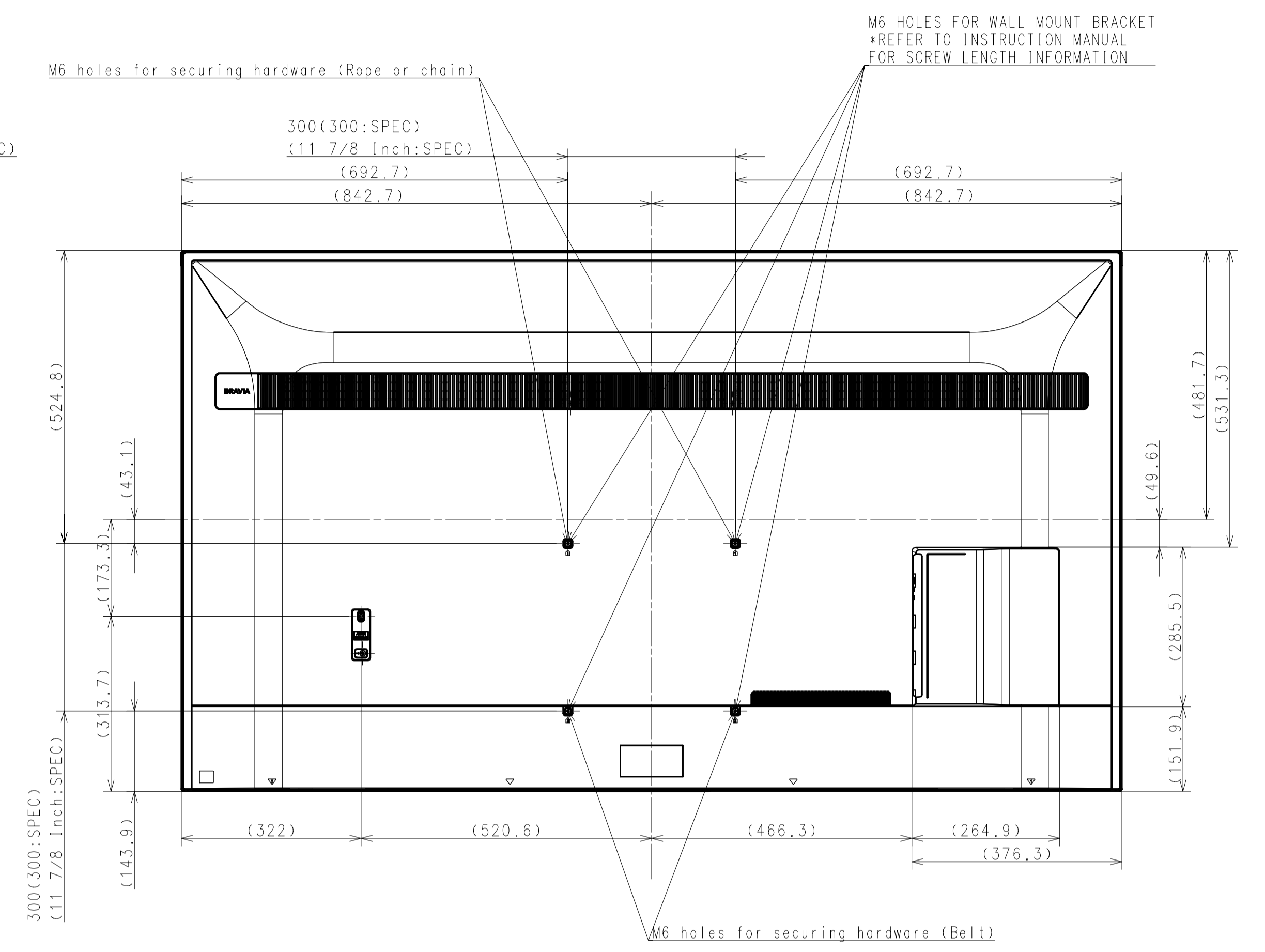

For NORTH AMERICA, GENERAL AREA

DESCRIPTION: 75(X80J) EXTERIOR VIEW	DATE: 08/15/12	SCALE: 1:7
DESCRIPTION: 75(X80J) EXTERIOR VIEW	TENTATIVE PART NO.:	SHEET/PAGES: 2 / 4
DRAWN BY: Sony Corporation		PART NO.:

SU-WL450

STANDARD

SLIM

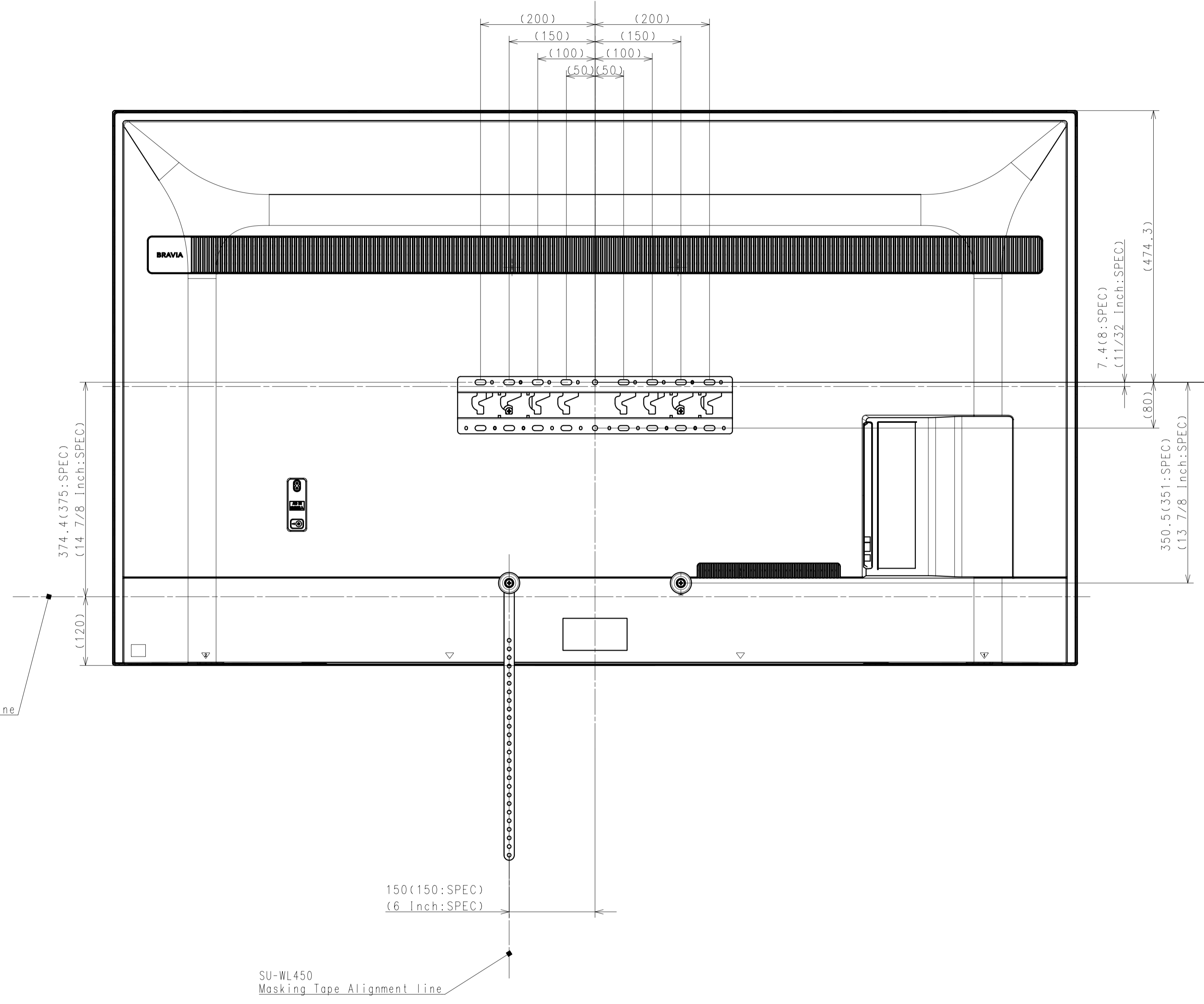

136.6 (137:SPEC)
(5 1/2 Inch:SPEC)

94.8 (95:SPEC)
(3 3/4 Inch:SPEC)

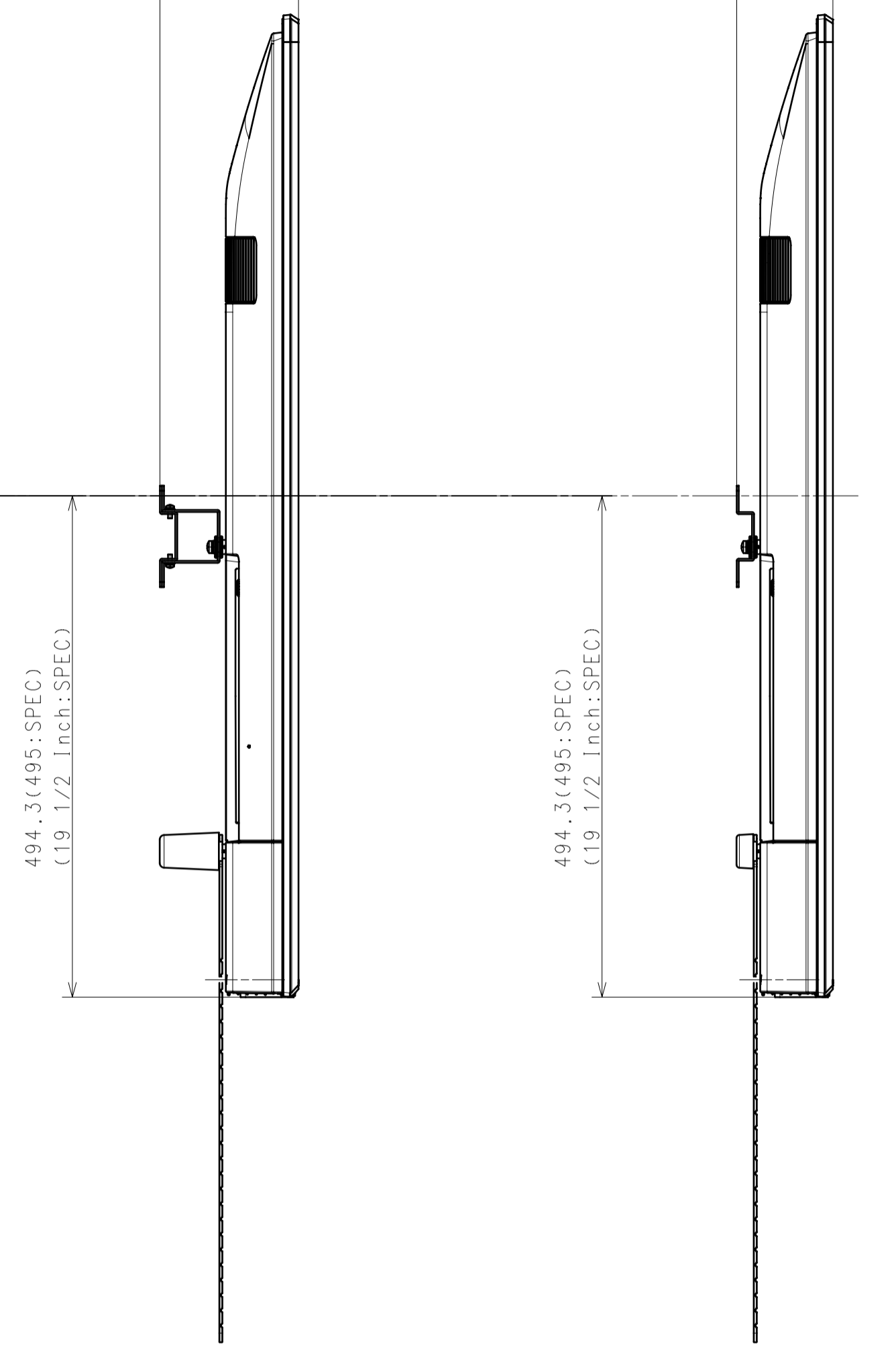

SONY STANDARD
DRAWING

DESCRIPTION 1	LEGAL OWNER	SCALE
75(X80J) EXTERIOR VIEW	Sony Corporation	1:5
DESCRIPTION 2	PART NO.	SHEET/PAGES
75(X80J) EXTERIOR VIEW		3 / 4

SU-WL 850

SU-WL 855 WITH LATERAL SHAFT BRACKET

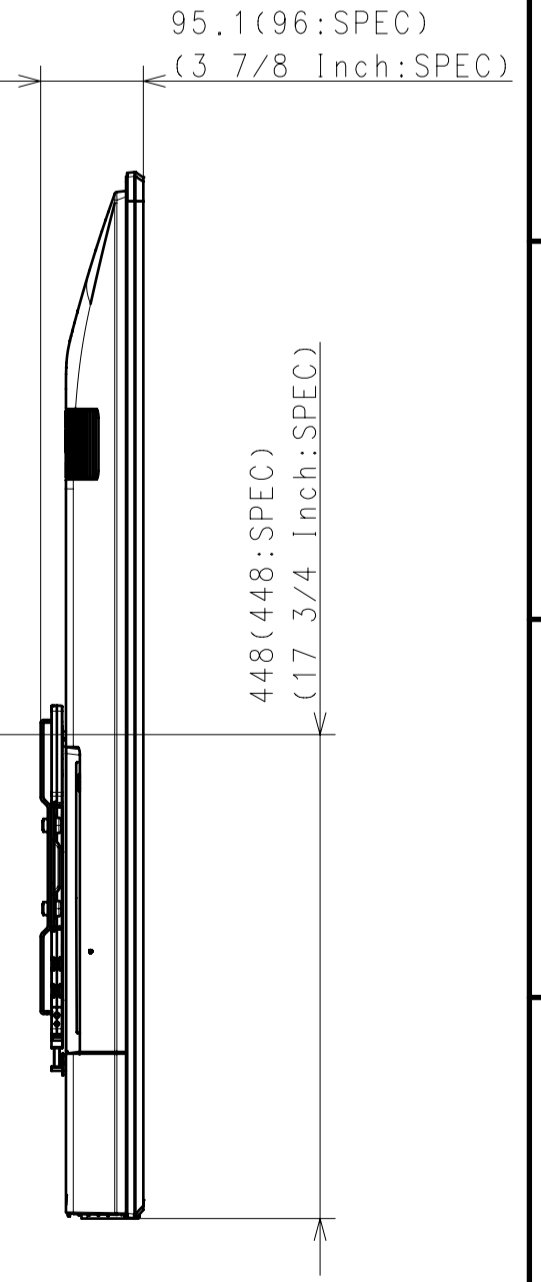
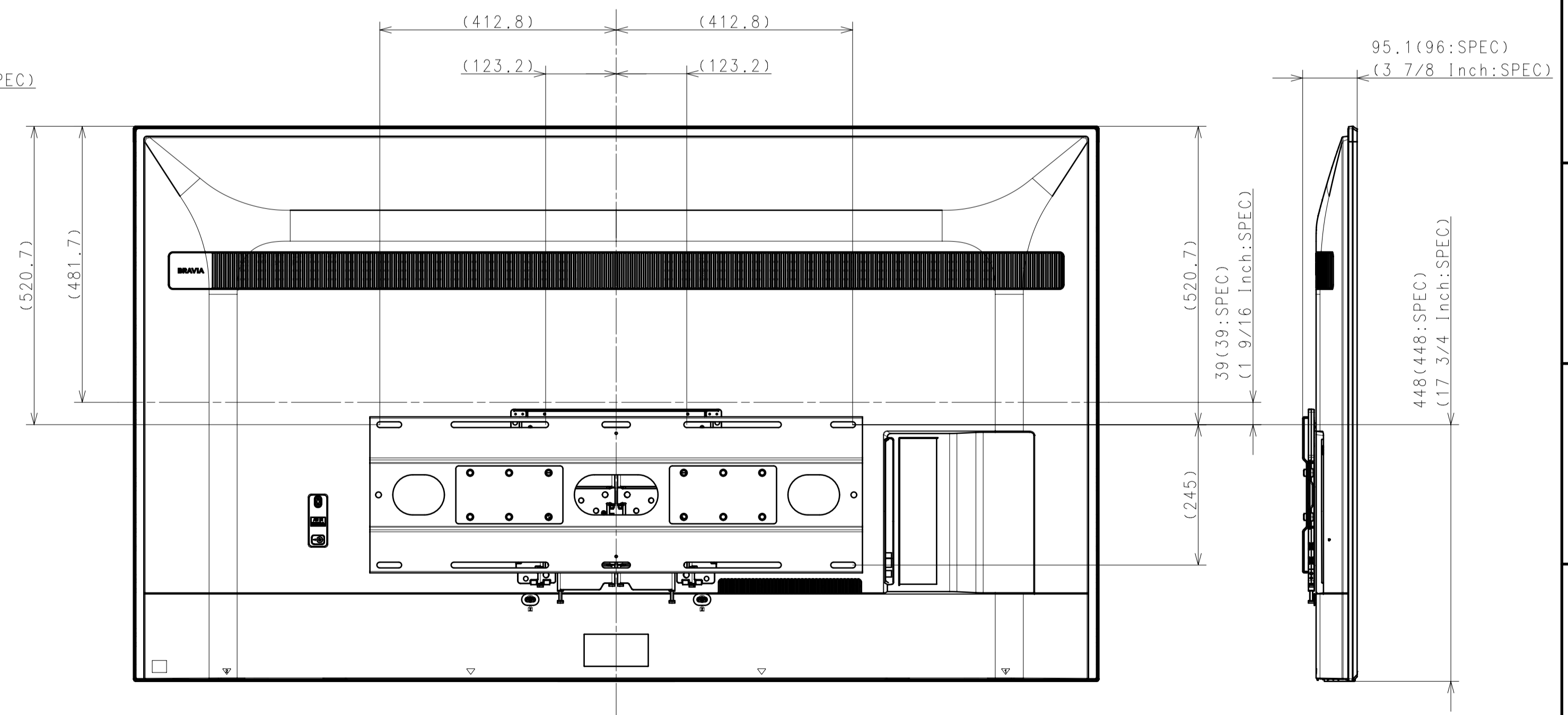
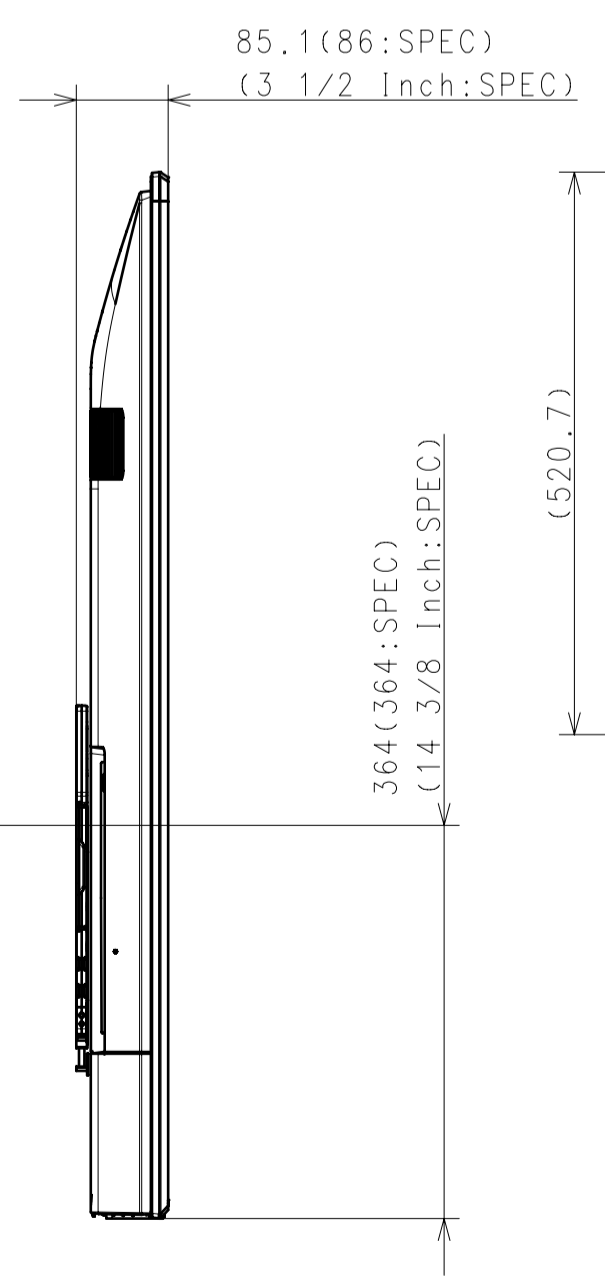
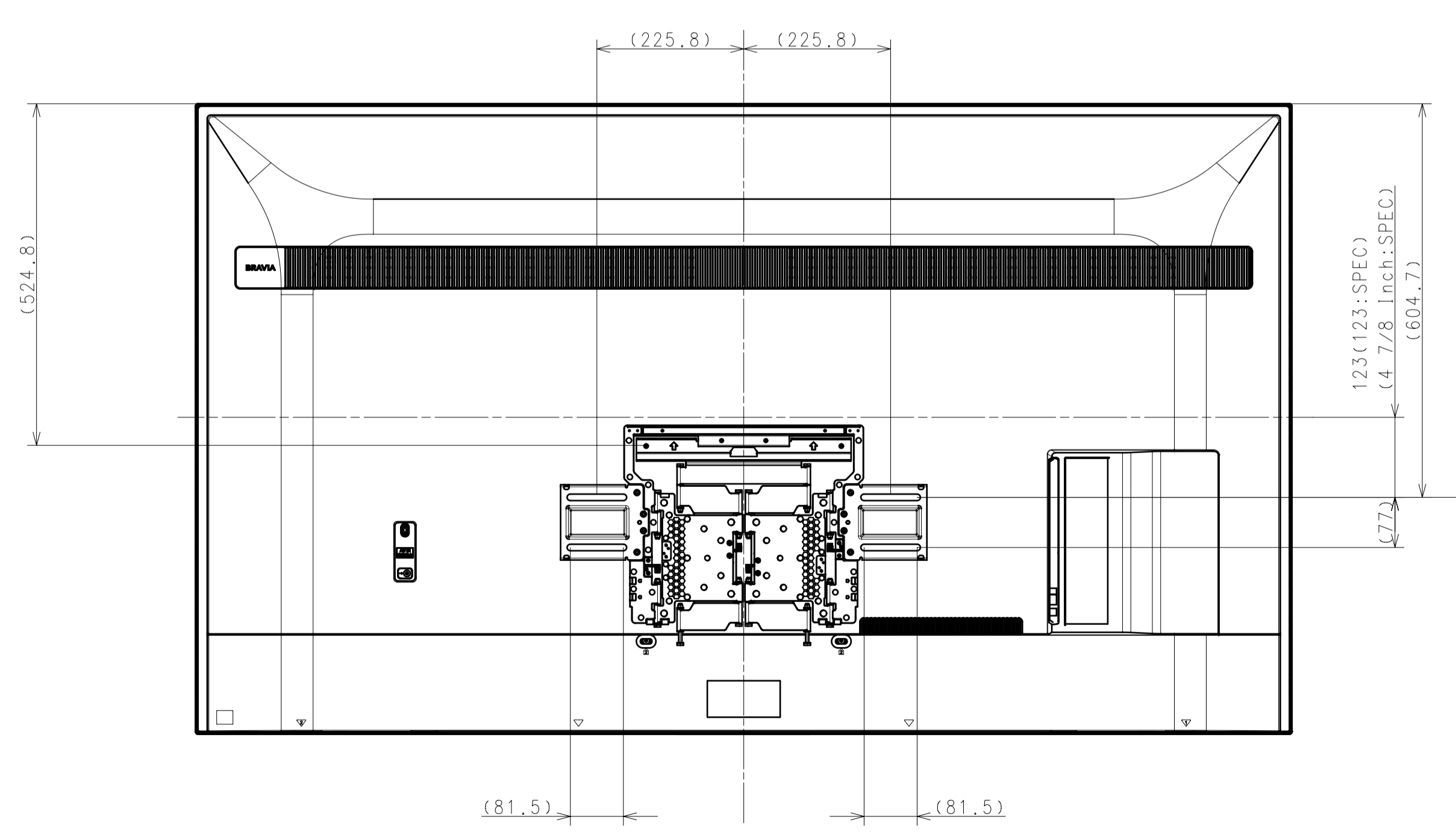
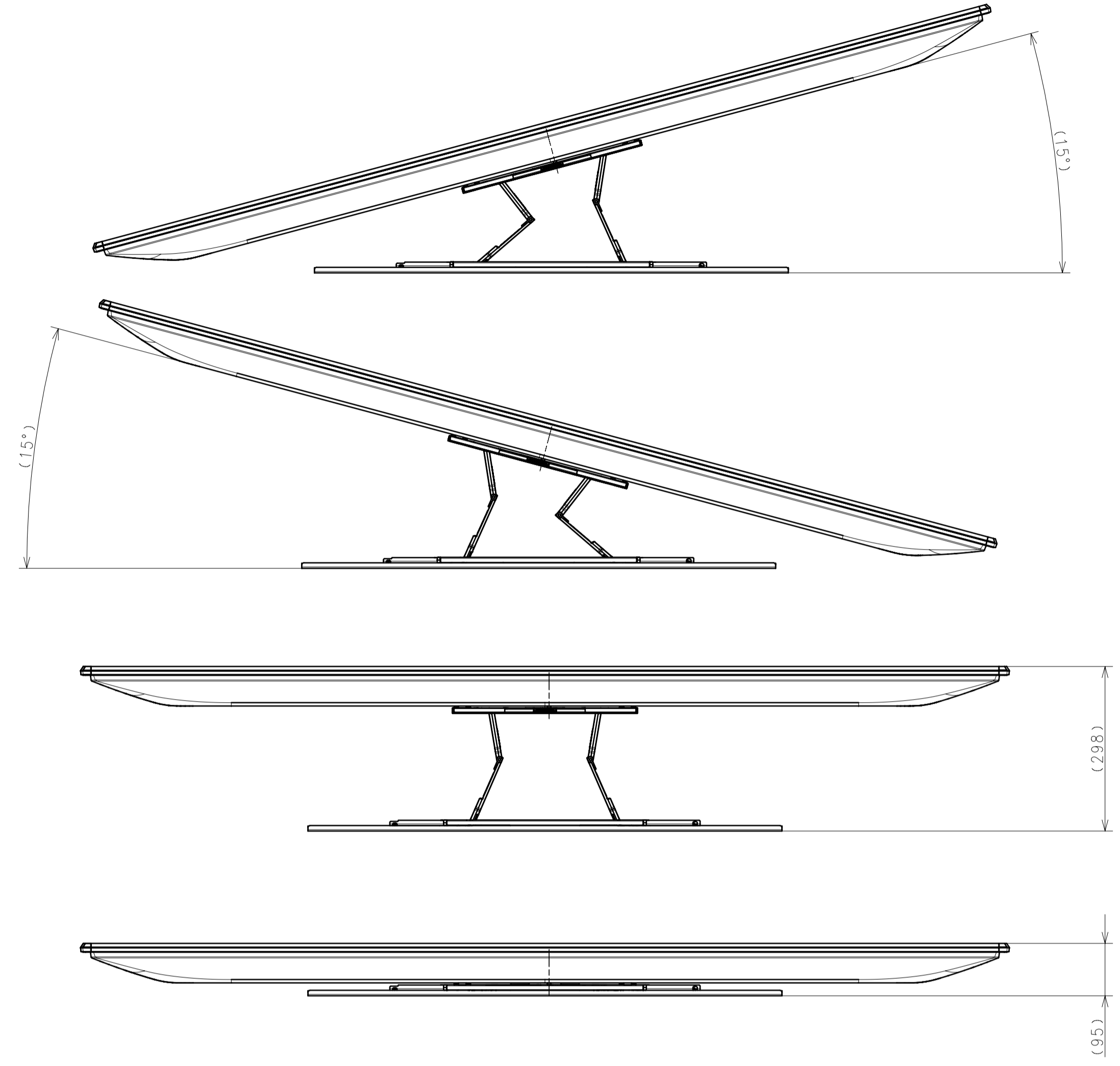
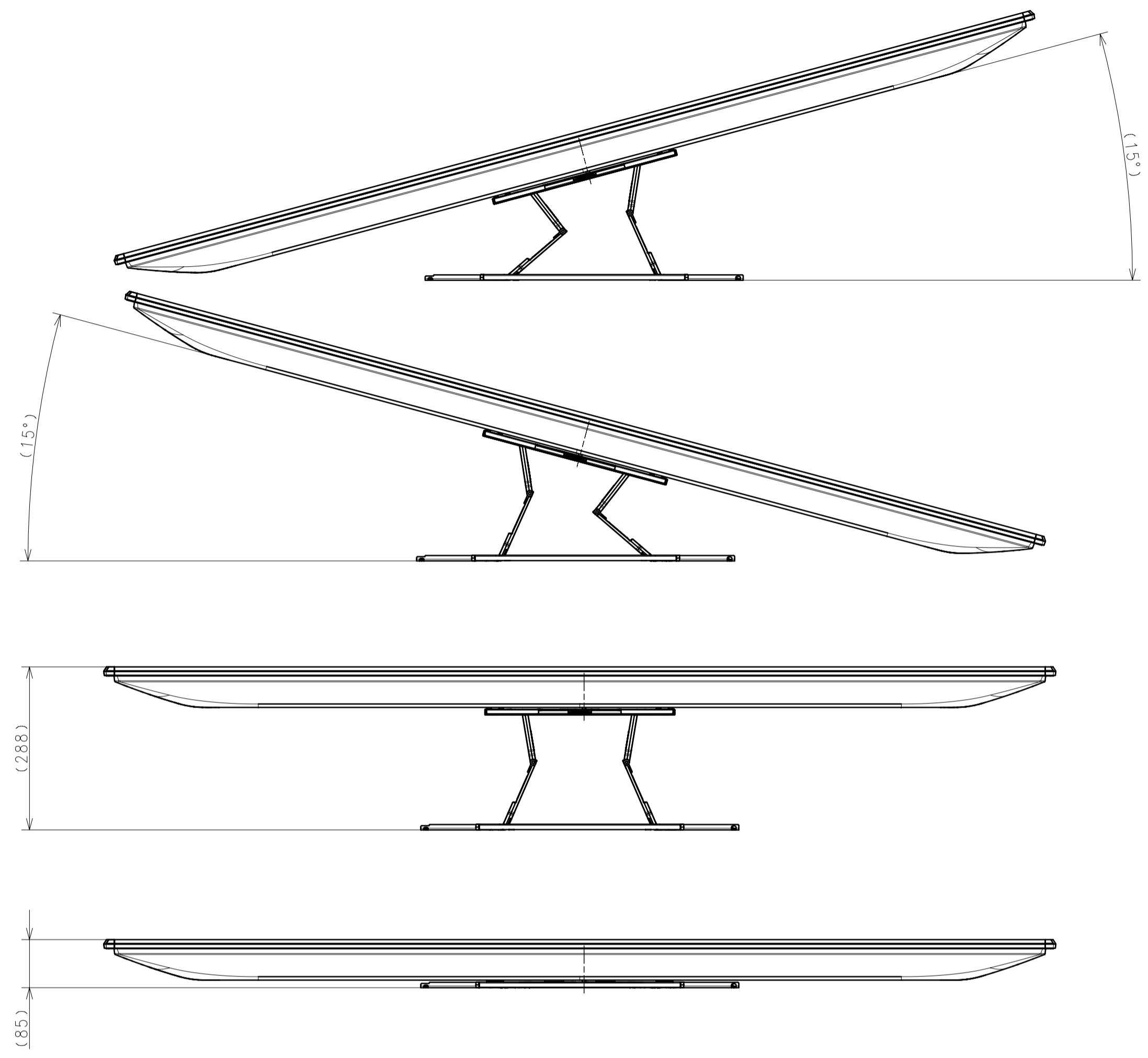

DESCRIPTION 1	75(X80J) EXTERIOR VIEW	LEGAL OWNER	Sony Corporation	SCALE	1:7
DESCRIPTION 2	75(X80J) EXTERIOR VIEW	PART NO.		SHEET/PAGES	4 / 4